



# CONSTRUCTION

## Company Profile

# level

group

Supplies | Works | Services

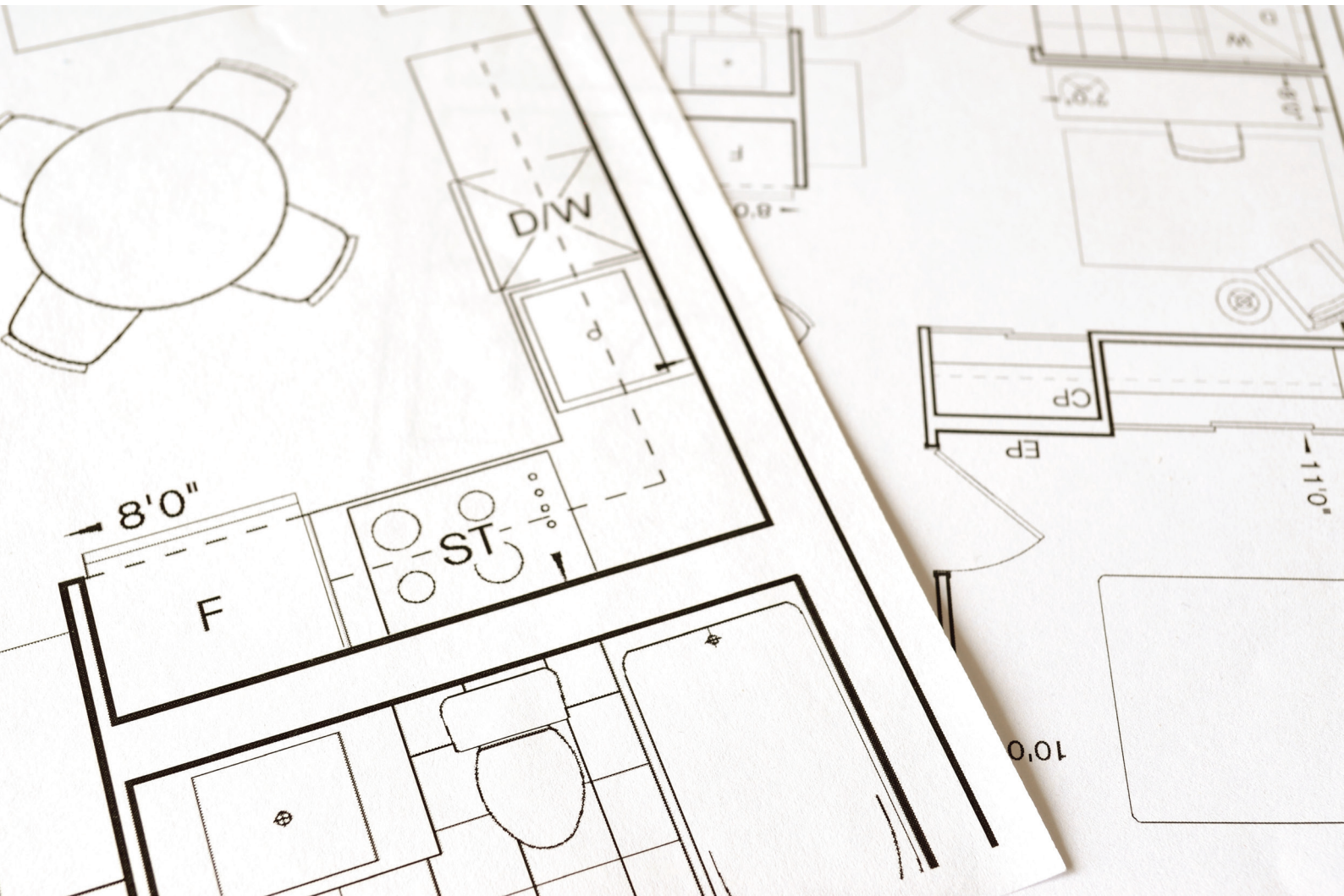

**Our success is driven by more than building facilities for our corporate, institutional and government clients.**



## Introduction

Level Group (Pty) Ltd has emerged as one of the respected general contracting firms in Botswana. We have proven our ability to take on large, complex projects and complete them on time, on budget and at the highest levels of quality. The company's position has evolved over the past few years with an increasing number of projects and an upward growing turnover. As the workload has increased the company's profile has been enhanced by providing further opportunities for greater abilities to be demonstrated.

Our success is driven by more than building facilities for our corporate, institutional and government clients. More and more of our clients are turning to us for our distinctive ability to implement innovative project management techniques and to serve as a reliable provider of knowledge-driven solutions for their complex construction projects. Our team of construction professionals offers a single-source solution for all your construction-related needs. Whether its restoration, site preparation, a new facility or facility renovation, we have the experience and personnel to provide the highest quality construction on schedule and within the budget.

## Mission

To sustain a high level of qualified personnel and build a professional team committed to serve our clients. Our pledge is to establish lasting relationships with our customers by exceeding their expectations and gaining their trust, through exceptional performance by every member of the construction team.

## Vision

To be the leading local firm in Botswana in the discipline of construction. Level Group (Pty) Ltd will strive to offer excellent services by providing high quality of work, applying the latest available technology for the industry, and seeking more joint ventures with international companies to have the opportunity in higher weighted projects.

## Core Values

### **Quality**

Building excellence

### **Safety**

No task is so important that we cannot find a safe way to do it.

### **Integrity**

We do the right thing for our customers and employees. We do what we say.

### **Resourcefulness**

We are a can-do, get-it-done company

### **Profitability**

We provide great value for a fair return. We strategically re-invest our profits to maintain operational excellence.

### **Customer satisfaction**

We listen, we build trusting relationships and we stand behind our work

### **Economic Inclusion & Diversity**

We are dedicated to being top of class in providing mentoring and opportunities for emerging firms.

### **Innovation**

We collaborate to innovate and deliver the highest expertise

### **Social Responsibility**

We are committed to the community, environment and employees

## Our Services

Building trusting relationships with our clients by being responsive to their expectations and providing the highest quality possible is the cornerstone of our corporate culture. Our attentiveness to our clients and all aspects of every project has resulted in long term and fertile client relationships. Shook practices and honest communication with our clients' trust is a priority from the get-go.

By being held accountable for our actions and offering complete transparency throughout the construction process, our clients have received not only higher quality projects on time and on budget, but also peace of mind that we acted as their agent with their best interests at heart.

# Below Is A Short Description Of Our Services

## **Pre-Construction Services** **Pre-Construction Estimation**

Provide project estimating and reliable cost model drawn from our extensive cost histories.

## **Feasibility Studies**

Analyze life cycle costs for building system alternatives.

## **Scheduling**

Develop a complete system schedule showing who and what goes where and when.

## **MEP REVIEW**

Evaluate evolving mechanical, electrical and plumbing system concepts and coordinate engineering services.

## **Constructability Review**

Help determine the ease and speed of the building process.

## **Risk Management**

Control cost, schedule and owner objectives to mitigate risk.

## **Market Analysis**

Understanding the unique requirements of you project in the context of market conditions and trends.

## **Cost Control**

Provide the most efficient design and construction methods to achieve value.

## **Quality Control**

Monitor methods, procedures and checks from start to finish with the goal of meeting established standards.

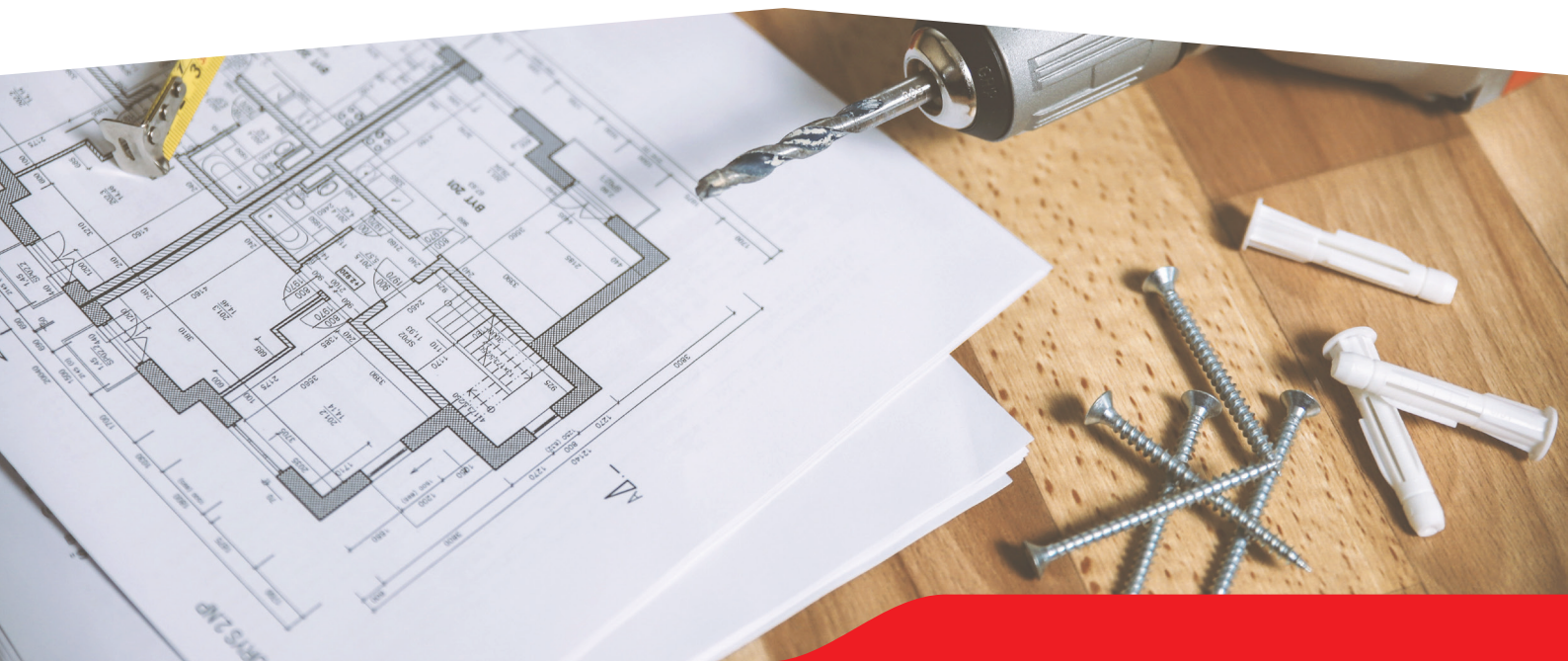

## Construction Services

### **LEED TM Certification**

Meet sustainable design and construction criteria for Leadership in Energy & Environmental Design certification and recognition.

### **Progress Monitoring**

Monitor actual schedules/budgets versus forecasted schedules/budgets.

### **Change Order Management**

Limit the need for revisions.

### **Quality Control & Testing**

Validation of actual requirements to specifications.

### **Labor Relations**

Proactive resolution of potential issues.

## Post Construction Services

### **Commissioning**

Ensure that building systems are designed, installed and activated according to owner's operational needs

### **Lien Releases**

Severing of contractual ties to vendors.

### **O & M**

Development of operations and maintenance instructions.

### **Final Closeout**

Completion of punch listed items.

### **One-Years Walkthrough**

Final verification of operational status.



## SPECIALISED FIELDS:

### 01 Building Construction Works and Maintenance

#### Sub-codes

01- Building Construction

Grade

OC



### 02 Electrical Engineering Works

#### Sub-codes

01- Electrical Installation

02- High Voltage Reticulation

03- Airfield Lightning

04- Automated Machinery and Control Systems

05- Photovoltaic Systems

06- Fire Detection Systems

07- Security System Installations

(CCTV, Access Control, Alarms, etc)

08- Radio/Telemetry

Grade

OC

OC

OC

OC

OC

OC

OC

OC

OC



### 03 Civil Engineering Works

#### Sub-codes

01- Construction (Roads, Infrastructure, Airfields)

02- Railways

03- Dams

04- Road Surfacing

05- Bridges

06- Water Supplies, Sanitation

Reticulation and Irrigation Works

Grade

OC

OC

OC

OC

OC

OC

OC



### 04 Works Maintenance

#### Sub-codes

01- Electrical

02- Mechanical

Grade

OC

OC

### 05 Water and Sewage Treatment Plants Works

#### Sub-codes

01- Water and Sewage Treatment Plan

Grade

OC

### 06 Mechanical Engineering Work

#### Sub-codes

01- Air Conditioning/ Refrigeration Systems

02- Solar Water Heating

03- Lifts, Hoists and Escalators

04- Fire Suppression Systems

05- Compressed Air Equipment Installations

06- Liquid Petroleum, Gas Installations and Equipment

Grade

OC

OC

OC

OC

OC

OC

OC

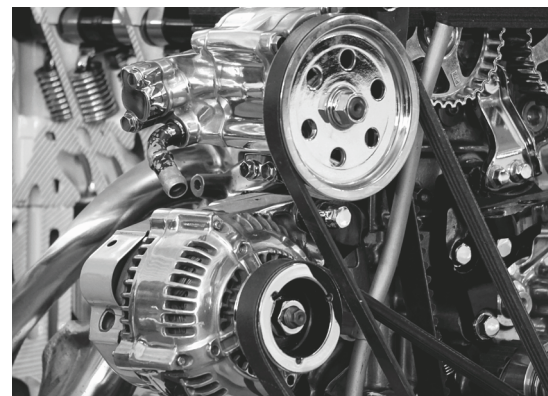

07- Low Pressure Water Systems	OC
08- Steam and Boiler Systems	OC
09- Laundry and Kitchen Equipment Installation and Services	OC
10- General Fabrication and Machine Shop Service	OC
11- Pumps and Munchers	OC

**07 Fencing- Buildings, Roads and Others**

**Sub-codes**

01- Fencing Works	OC
02- Electrical Works	OC

**08 Roads- Ancillary**

**Sub-codes**

01- Road Marking	OC
02- Signs	OC
03- Road Routine Maintenance (Labour Based)	OC
04- Road Guard Rails/ Kerbing	OC
05- Road Bush Clearing/ De-Stumping	OC



**CULTURE**

Level Group (Pty) Ltd culture begins with our people; we like to think of ourselves as one big family working together toward one goal - Building excellence. Our company culture is a mixture of hard work, fun, mutual respect and a strong commitment to our clients and community. There is close friendship among the employees of this company that adds value to their working and personal lives. We strive to maintain an open, family-like atmosphere in our offices and on our job sites. Like most families, our expectations are high. We recruit and retain only the most talented and enthusiastic employees, many of whom have a proclivity for success.

**SAFETY**

We are committed to safety above all else, and this commitment is central to everything we do. Our proactive approach creates value for our clients and safeguards our most important asset; our employees. Our team is dedicated to maintaining a safety-focused and environmentally sound business; our safety culture is promoted by each member of our team through planning, implementing and evaluating safety practices on a daily basis. Our safety program is proactive and action-oriented; everyone from management to trades people are involved in making a zero-incident workplace a reality. We use daily pre-task planning sessions, on-going safety inspections, weekly safety meetings, safety seminars, special equipment training, safety manual reviews and email updates to assist in attaining our goal of zero incident.



**“Safety; The Only Way To Work!”**  
**| That is the motto we live by. ”**



📍 Plot 20596  
Block 3 Industrial  
Gaborone, Botswana

☎ Tel: (+267) 311 7095

📠 Fax: (+267) 311 7095

📱 Mobile: (+267) 72 900 111  
(+267) 71 707 010

🌐 Email: [levelgroup@gmail.com](mailto:levelgroup@gmail.com)  
[info@levelgroup.co.bw](mailto:info@levelgroup.co.bw)

Web: [www.levelgroupbw.co.bw](http://www.levelgroupbw.co.bw)